

MÜNCHEN RADAR	125.620 126.170	TOWER	122.920	Mag. Variation	2° E
	131.020 129.100		GROUND		121.970
		APRON	121.750	Transition altitude	5000'
		ATIS	118.870	Transition level	by ATC

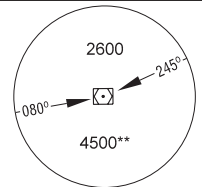

MSA 25 NM
DRN DVORDME*
* German Territory only
** 10 NM 3100

**ABKIS 04, GARKI 04
HDO 04, OSKAN 04
RIVSA 04
RWY 04 RNAV APPROACH
TRANSITIONS**

GPS- OR FMS-EQUIPPED AIRCRAFT; USE OF RNAV TRANSITION ONLY WHEN CLEARED BY ATC

GPS/FMS CLEARANCE PHRASEOLOGY

- "Cleared xxx Transition":**
Authorization to fly the lateral part of a GPS/FMS routing, including assigned speeds. Altitudes will be issued by ATC.
- "Cleared xxx Transition and Profile":**
Authorization to fly the GPS/FMS routing including assigned speeds and altitudes.
- "Cleared direct to Waypoint xxx":**
Authorization to fly from the present position to one waypoint or combination of waypoints, including the continuation of the lateral part adjoining the last waypoint, including assigned speeds. Altitudes will be issued by ATC.

When reaching clearance limit OSKAN proceed to RIVSA and hold. Expect GPS/FMS transition or radar vectoring to final.

CLEARANCE LIMIT GARKI
N51 23.1 E014 07.0

CLEARANCE LIMIT OSKAN
N51 27.7 E013 37.7

EPILA
N51 11.6 E013 37.9
11 DME DRN
At or above FL80

CLEARANCE LIMIT HERMSDORF
D 115.00 HDO
N50 55.7 E014 22.1

DRESDEN
D 114.35 DRN
N51 00.9 E013 35.9

(FAF) GOMPA
N50 59.9 E013 34.9
At or above 4000'

When reaching clearance limit HDO proceed to GARKI and hold. Expect GPS/FMS transition or radar vectoring to final.

NOT TO SCALE

SPEED RESTRICTION
MAX 250 KT below FL100
or as by ATC

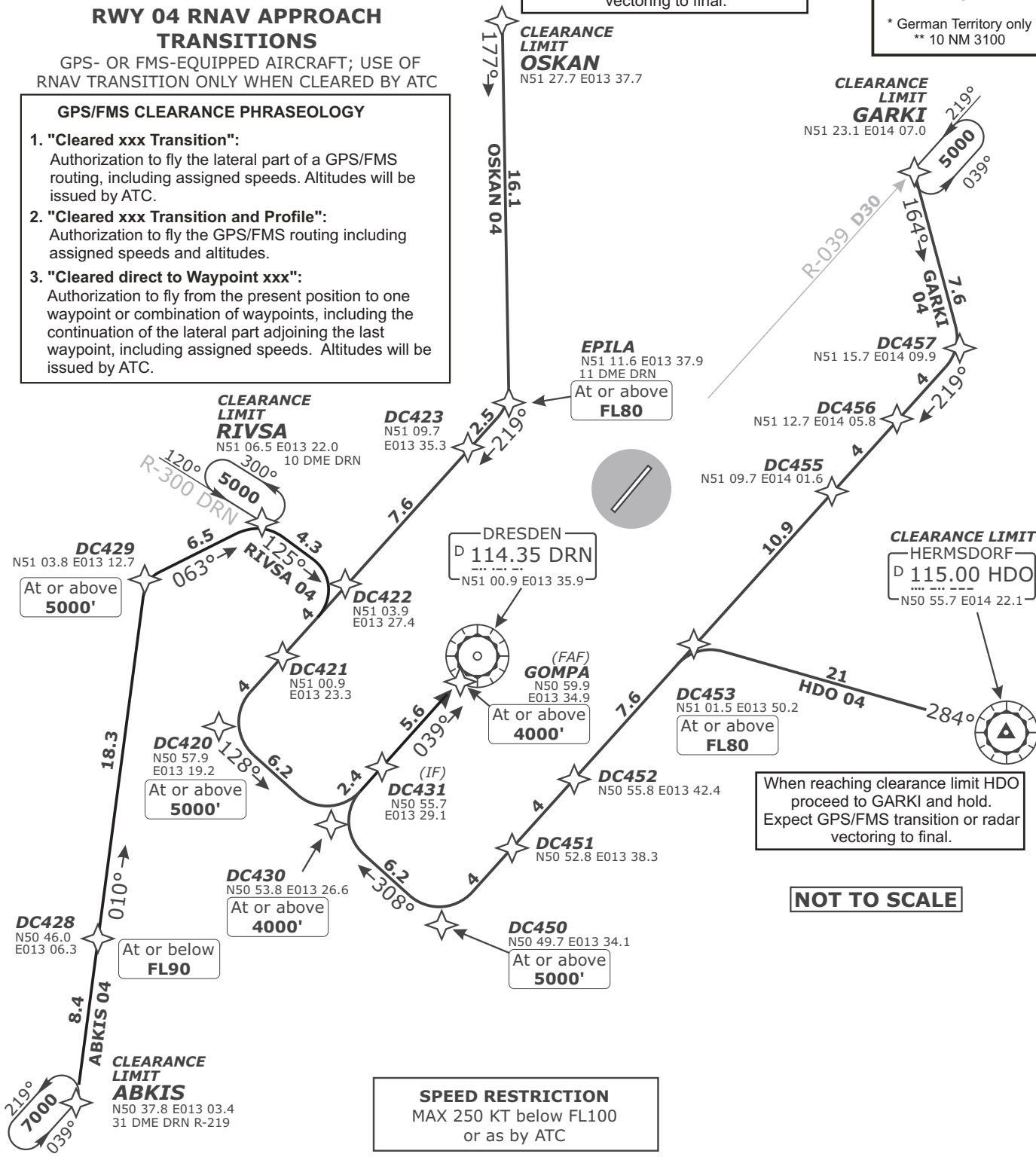

TRANSITION	ROUTING
ABKIS 04	ABKIS - DC428 (FL90 -) - DC429 (5000' +) - RIVSA (5000' +) - DC422 (5000' +) - DC420 (5000' +) - DC430 (4000' +) - GOMPA (4000' +)
GARKI 04	GARKI - DC457 - DC453 (FL80 +) - DC450 (5000' +) - DC430 (4000' +) - GOMPA (4000' +).
HDO 04	HDO - DC453 (FL80+) - DC450 (5000'+) - DC430 (4000' +) - GOMPA (4000' +).
OSKAN 04	OSKAN - EPILA (FL80 +) - DC420 (5000' +) - DC430 (4000' +) - GOMPA (4000' +).
RIVSA 04	RIVSA - DC422 - DC420 (5000' +) - DC430 (4000' +) - GOMPA (4000' +).

Revision: 2010-10-28. Changes: ED-R 75 withdrawn.

Valid for flight simulation use only - do not use for real life navigation

MÜNCHEN RADAR 125.620 126.170
131.020 129.100

TOWER 122.920
GROUND 121.970
APRON 121.750
ATIS 118.870

Mag. Variation 2° E
Elevation 754'
Transition altitude 5000'
Transition level by ATC

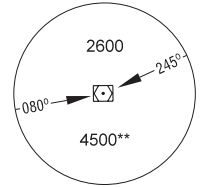

MSA 25 NM
DRN DVORDME*

* German Territory only
** 10 NM 3100

**ABKIS 22, GARKI 22, HDO 22
OSKAN 22, RIVSA 22
RWY 22 RNAV APPROACH TRANSITIONS**

GPS- OR FMS-EQUIPPED AIRCRAFT; USE OF
RNAV TRANSITION ONLY WHEN CLEARED BY ATC

SPEED RESTRICTION
MAX 250 KT below FL100
or as by ATC

When reaching clearance limit OSKAN
proceed to GARKI and hold.
Expect GPS/FMS transition or radar
vectoring to final.

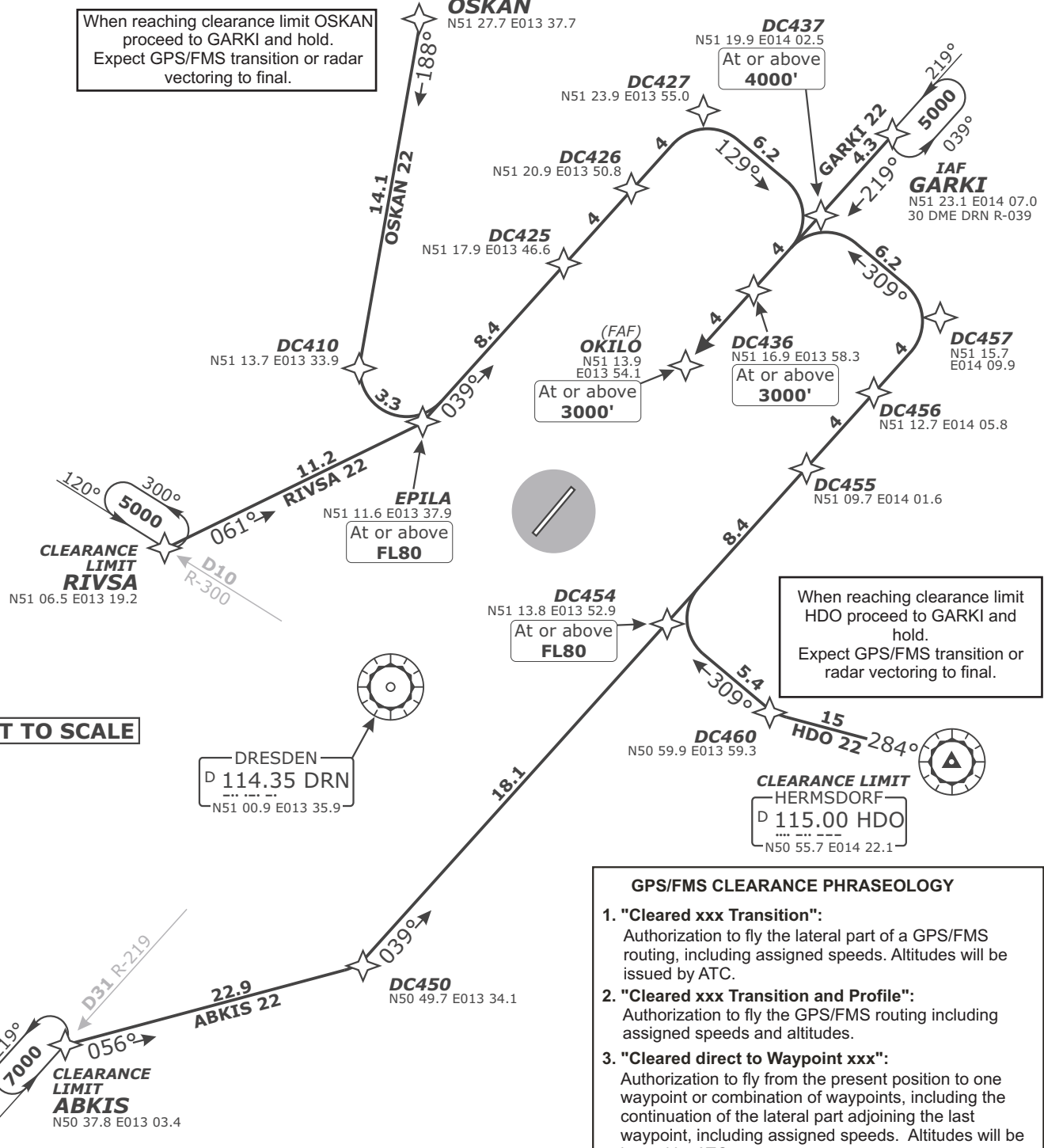

CLEARANCE LIMIT RIVSA
N51 06.5 E013 19.2

EPILA
N51 11.6 E013 37.9
At or above FL80

OKILO (FAF)
N51 13.9 E013 54.1
At or above 3000'

DC436
N51 16.9 E013 58.3
At or above 3000'

DC454
N51 13.8 E013 52.9
At or above FL80

When reaching clearance limit
HDO proceed to GARKI and
hold.
Expect GPS/FMS transition or
radar vectoring to final.

CLEARANCE LIMIT HERMSDORF
D 115.00 HDO
N50 55.7 E014 22.1

NOT TO SCALE

DRESDEN
D 114.35 DRN
N51 00.9 E013 35.9

GPS/FMS CLEARANCE PHRASEOLOGY

- "Cleared xxx Transition":**
Authorization to fly the lateral part of a GPS/FMS routing, including assigned speeds. Altitudes will be issued by ATC.
- "Cleared xxx Transition and Profile":**
Authorization to fly the GPS/FMS routing including assigned speeds and altitudes.
- "Cleared direct to Waypoint xxx":**
Authorization to fly from the present position to one waypoint or combination of waypoints, including the continuation of the lateral part adjoining the last waypoint, including assigned speeds. Altitudes will be issued by ATC.

TRANSITION	ROUTING
ABKIS 22	ABKIS - DC450 - DC454 (FL80+) - DC457 - DC437 (4000'+) - DC436 (3000'+) - OKILO (3000'+).
GARKI 22	GARKI - DC437 (4000'+) - DC436 (3000'+) - OKILO (3000'+).
HDO 22	HDO - DC460 - DC454 (FL80+) - DC457 - DC437 (4000'+) - DC436 (3000'+) - OKILO (3000'+).
OSKAN 22	OSKAN - DC410 - EPILA (FL80+) - DC427 - DC437 (4000'+) - DC436 (3000'+) - OKILO (3000'+).
RIVSA 22	RIVSA - EPILA (FL80+) - DC427 - DC437 (4000'+) - DC436 (3000'+) - OKILO (3000'+).

Revision: 2010-10-28. Changes: ED-R 75 withdrawn.

Valid for flight simulation use only - do not use for real life navigation