

ATIS 123.950	Leipzig Tower 125.950 121.100	Leipzig Ground 121.670	Leipzig Delivery 121.800	München Radar 126.170 133.570 131.020 129.100
-----------------	----------------------------------	---------------------------	-----------------------------	--

Apt. Elev. 470'

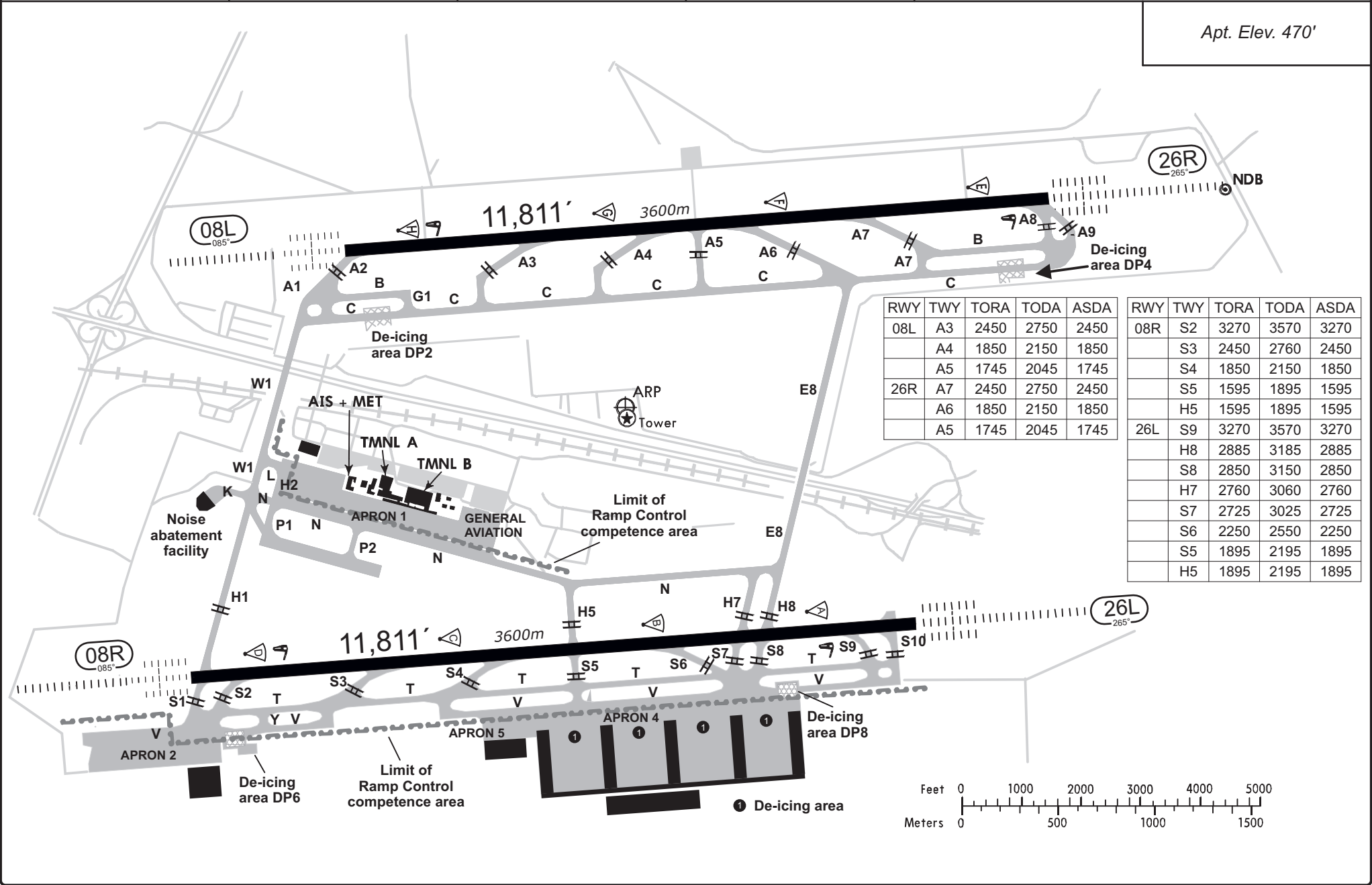

RWY	TWY	TORA	TODA	ASDA	RWY	TWY	TORA	TODA	ASDA
08L	A3	2450	2750	2450	08R	S2	3270	3570	3270
	A4	1850	2150	1850		S3	2450	2760	2450
	A5	1745	2045	1745		S4	1850	2150	1850
26R	A7	2450	2750	2450	S5	1595	1895	1595	
	A6	1850	2150	1850	H5	1595	1895	1595	
	A5	1745	2045	1745	26L	S9	3270	3570	3270
					H8	2885	3185	2885	
					S8	2850	3150	2850	
					H7	2760	3060	2760	
					S7	2725	3025	2725	
					S6	2250	2550	2250	
					S5	1895	2195	1895	
					H5	1895	2195	1895	



Valid for flight simulation use only - do not use for real life navigation

OLD AERODROME LAYOUT (ONLY FOR COMPATIBILITY)

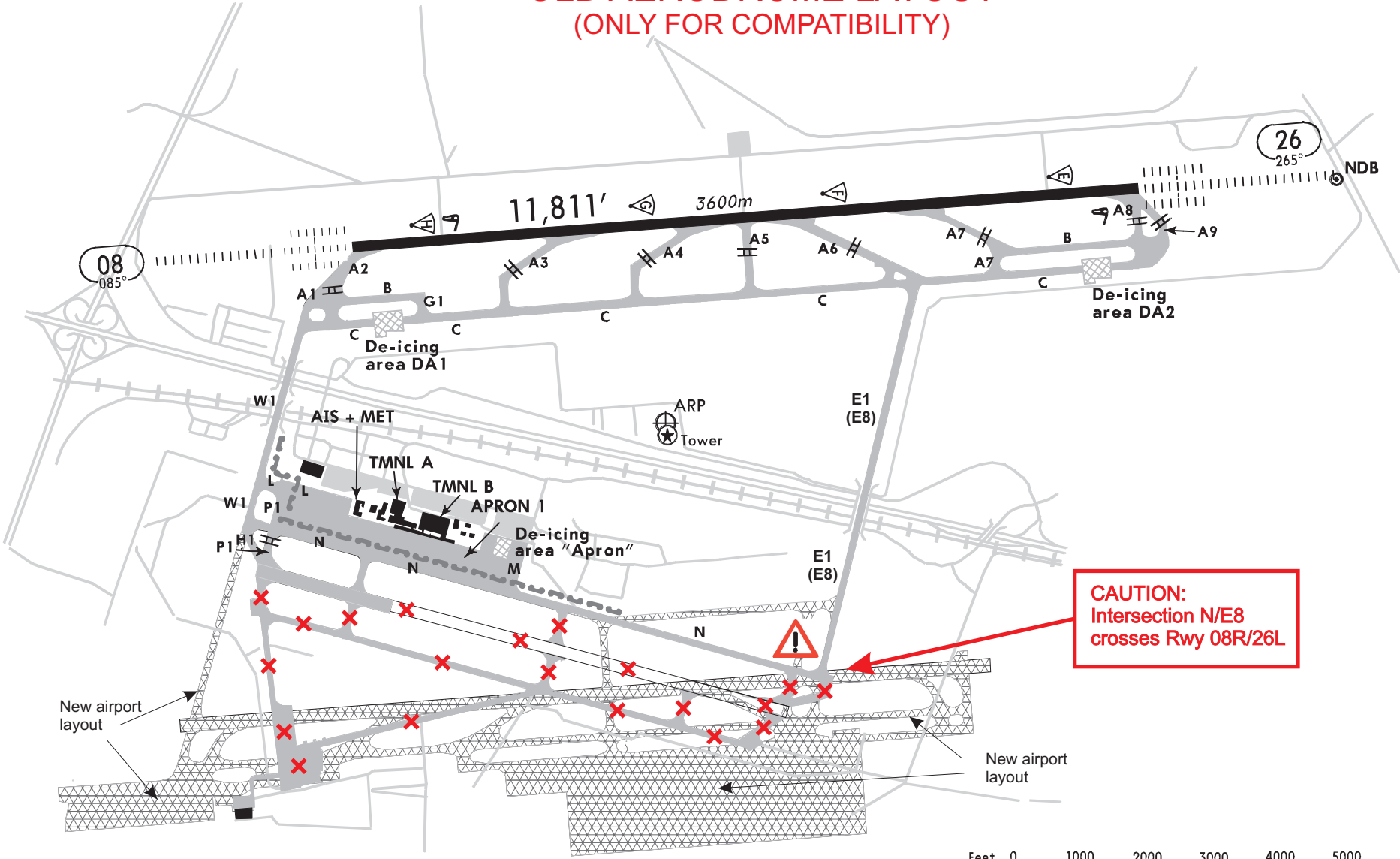

CAUTION:
Intersection N/E8
crosses Rwy 08R/26L

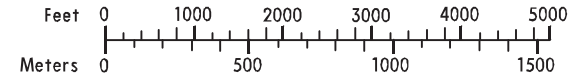

Valid for flight simulation use only - do not use for real life navigation

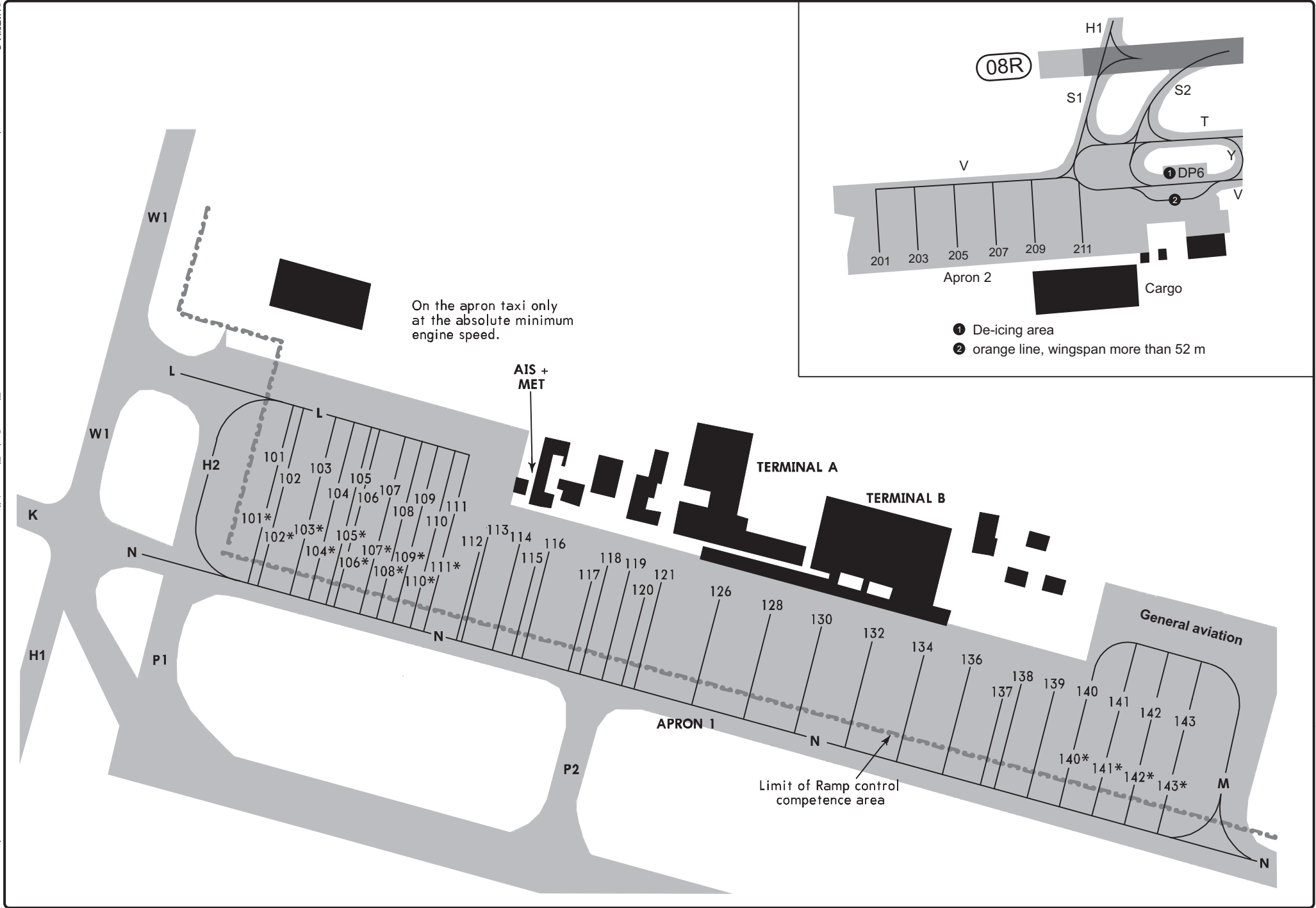

Valid for flight simulation use only - do not use for real life navigation

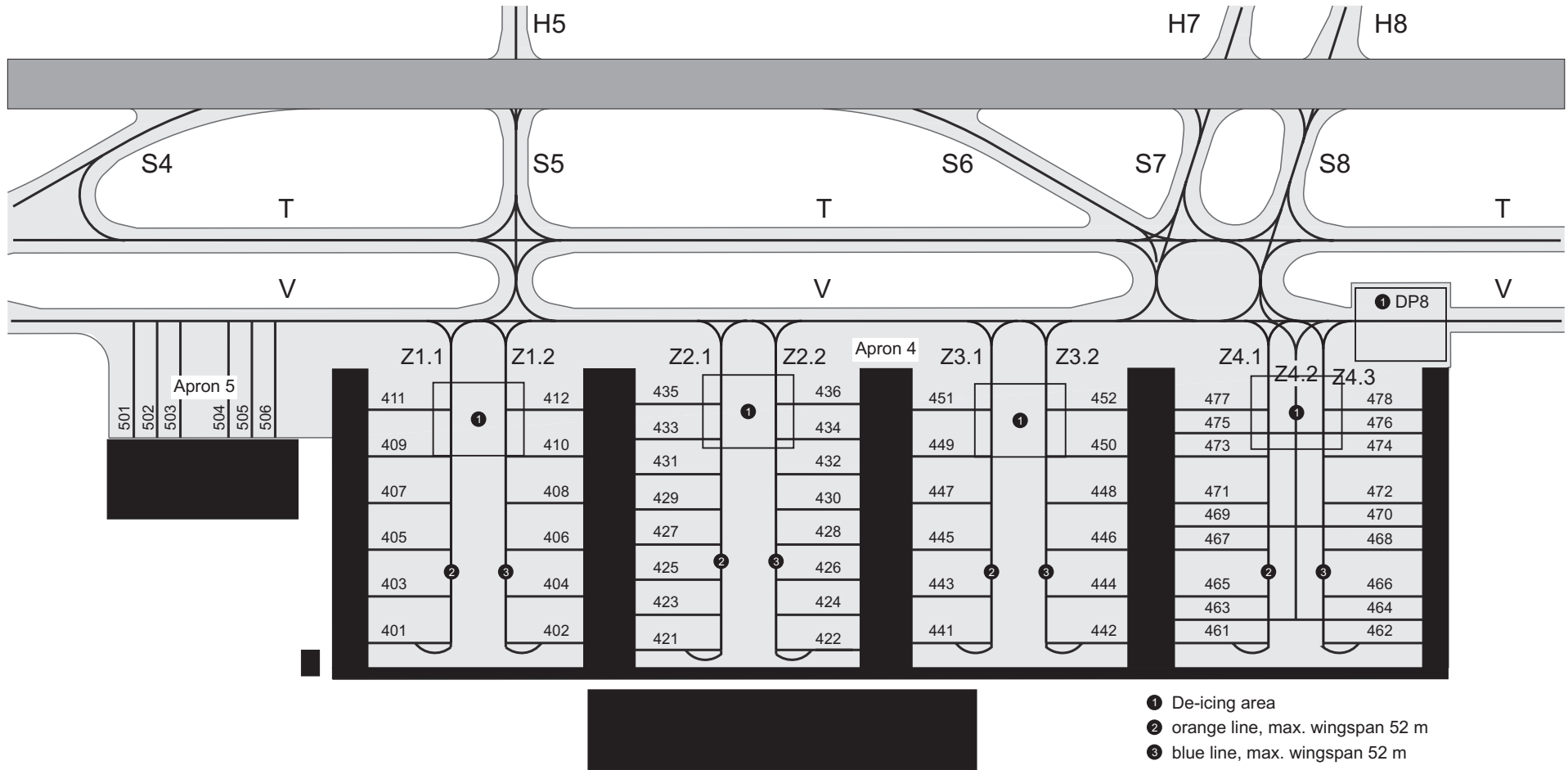

Valid for flight simulation use only - do not use for real life navigation

Runway Physical Characteristics

Designations RWY No	True Bearing	Dimensions of RWY (m)	Strength (PCN) and surface of RWY and SWY	THR coordinates	THR elevation and highest elevation of TDZ of precision APP RWY
1	2	3	4	5	6
08L	086°	3600 x 45	105/R/A/W/T CONC	N 51 25 52.469 E 012 12 56.974	THR 418 ft
26R	266°	3600 x 45	105/R/A/W/T CONC	N 51 26 01.134 E 012 16 02.802	THR 448 ft
08R	086°	3600 x 60	105/R/C/W/T CONC	N 51 24 41.789 E 012 12 16.734	THR 428 ft
26L	266°	3600 x 60	105/R/C/W/T CONC	N 51 24 50.473 E 012 15 22.490	THR 470 ft

Declared Distances

RWY Designator	TORA (m)	TODA (m)	ASDA (m)	LDA (m)	Remarks
1	2	3	4	5	6
08L	3600	3900	3600	3600	-
26R	3600	3900	3600	3600	-
08R	3600	3900	3600	3600	-
26L	3600	3900	3600	3600	-

TAKE OFF RUN AVAILABLE

<u>RWY 08L</u>	From rwy head	11811' (3600 m)	<u>RWY 08R</u>	From rwy head	11811' (3600 m)
	twy int A3	8038' (2450 m)		twy int S2	10728' (3270 m)
	twy int A4	6070' (1850 m)		twy int S3	8038' (2450 m)
	twy int A5	5725' (1745 m)		twy int S4	6070' (1850 m)
				twy int S5	5233' (1595 m)
				twy int H5	5233' (1595 m)
<u>RWY 26R</u>	From rwy head	11811' (3600 m)	<u>RWY 26L</u>	From rwy head	11811' (3600 m)
	twy int A7	8038' (2450 m)		twy int S9	10728' (3270 m)
	twy int A6	6070' (1850 m)		twy int H8	9465' (2885 m)
	twy int A5	5725' (1745 m)		twy int S8	9350' (2850 m)
				twy int H7	9055' (2760 m)
				twy int S7	8940' (2725 m)
				twy int S6	7382' (2250 m)
				twy int S5	6217' (1895 m)
				twy int H5	6217' (1895 m)

Approach and Runway Lighting

RWY designator	APCH light type INTST	THR light colour INTST	PAPI MEHT	TDZ, light	RWY centre line light spacing colour, INTST	RWY edge light colour INTST	RWY end light colour INTST	SWY light colour
1	2	3	4	5	6	7	8	9
08L	W VRB LIH/LIL	G VRB LIH/LIL	3° 57.0 ft	W VRB LIH	* 15 m spacing	W VRB LIH	R VRB LIH/LIL	-
26R	W VRB LIH/LIL	G VRB LIH/LIL	3° 56.0 ft	W VRB LIH	* 15 m spacing	W VRB LIH/LIL	R VRB LIH/LIL	-
08R	W VRB LIH/LIL	G VRB LIH/LIL	3° 64.0 ft	W VRB LIH	* 15 m spacing	W VRB LIH/LIL	R VRB LIH/LIL	-
26L	W VRB LIH/LIL	G VRB LIH/LIL	3° 64.0 ft	W VRB LIH	* 15 m spacing	W VRB LIH/LIL	R VRB LIH/LIL	-

Remarks: * Up to 2700m: W VRB LIH; 2700 – 3300m: R/W VRB LIH; 3300 – RWE: R VRB LIH.
 ** Sequence flash available.
 RETILs (acc ICAO Annex 14, Chapter 5.3.14): on RWY 08R for TWY S6
 on RWY 26L for TWY S3 and S4